

Drop-in Cartridge Cavities

VC-T001

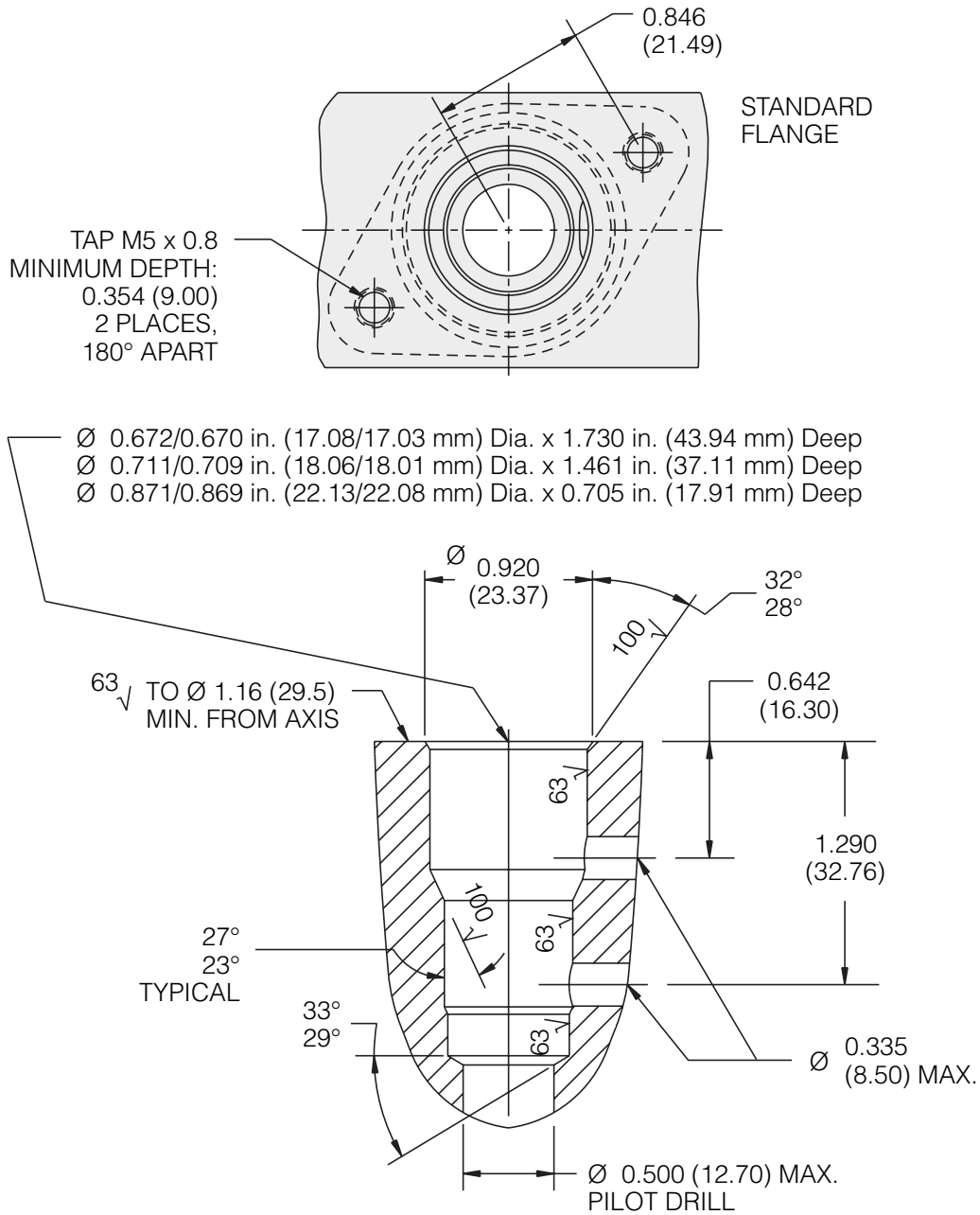

INCH (MILLIMETER)

The above features (except for pilot drill & cross drills) can be machined simultaneously with a form tool.

All diameters, with exception of 0.500 in. (12.7 mm) Pilot Drill to be concentric within 0.002 in. (0.05 mm) T.I.R. and perpendicular to face within 0.002 in. (0.05 mm) T.I.R.

Unspecified tolerances are ±0.005 in. (0.13 mm).

Drop-in Cartridge Cavities

VC-T009

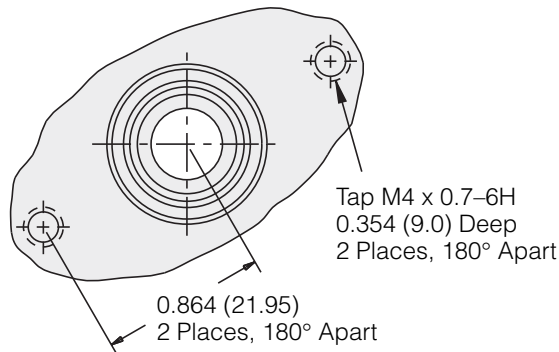

- ⊙ 0.517/0.515 Dia. x 1.161 Deep *
(13.134/13.084 x 29.50 Deep)
- ⊙ 0.596/0.594 Dia. x 0.780 Deep *
(15.134/15.084 x 19.80 Deep)
- ⊙ 0.661/0.654 Dia. x 0.331 Deep *
(16.80/16.60 x 8.40 Deep)

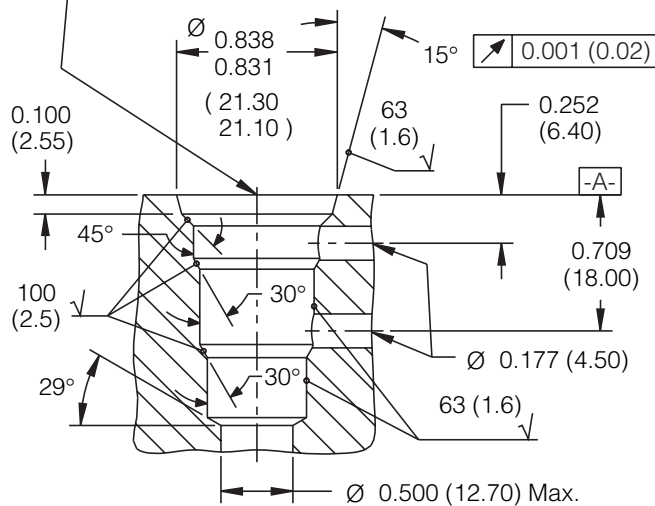

Inch (Millimeter)

The above features (except for pilot drill and cross drills) can be machined simultaneously with a form tool.

Cavity Tools: Rough: 7540420; Finish: 7540430;
Finish with Tungsten Carbide Inserts: 7540435

- ⊙ — These diameters to be concentric within 0.002 T.I.R. and perpendicular to spotface within 0.001 T.I.R.

* — Depths are from datum -A-

Unspecified tolerances are ±0.005

Drop-in Cartridge Cavities

VC-T011

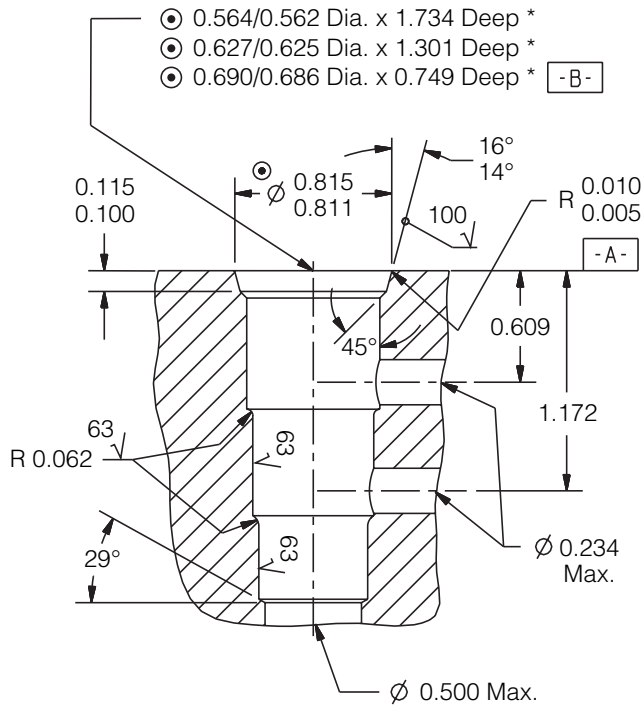
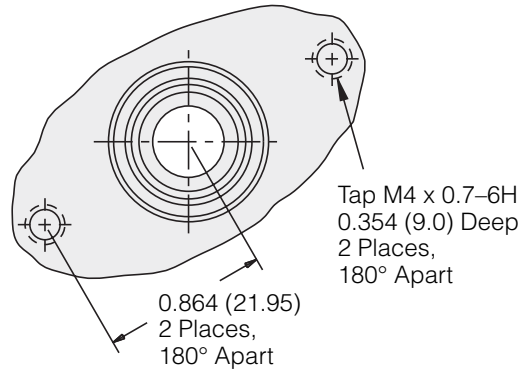

* -	\nearrow	0.002	B
	\perp	0.001	A

- * — Depths are from datum -A-
 Unspecified tolerances are ± 0.005
 Unspecified angular dimensions are $\pm 3^\circ$

Inch (Millimeter)

Drop-in Cartridge Cavities

VC-T004

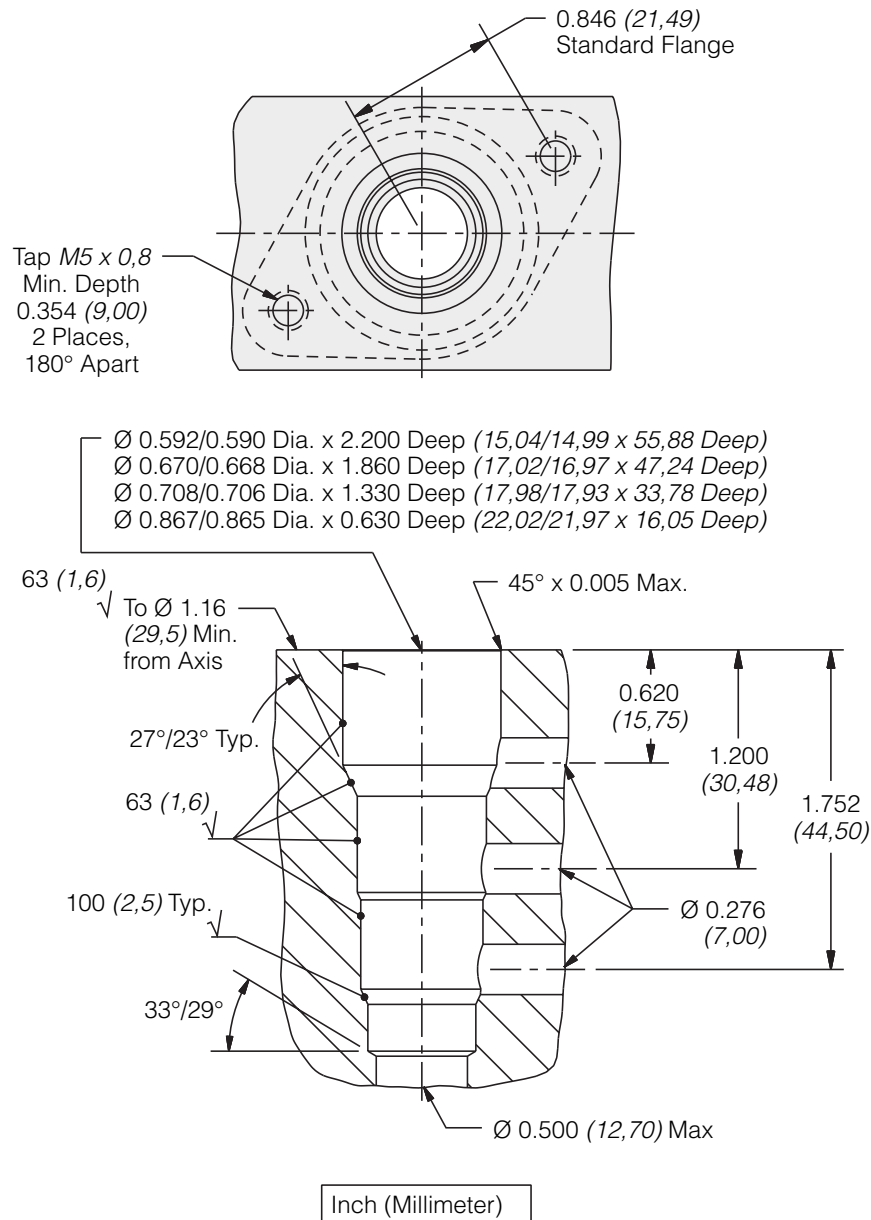

The above features (except for pilot drill and cross drills) can be machined simultaneously with a form tool.

Cavity Tools: Rough: 7540150; Finish: 7540170;
Finish with Tungsten Carbide Inserts: 7540160

These diameters, with exception of \varnothing 0.500 (12,70) Pilot Drill, to be concentric within 0.002 (0,05) T.I.R. and perpendicular to spotface within 0.002 (0,05).

Unspecified tolerances are ± 0.005 (0,13).

Surface finish specifications are in Micrometers (Micrometers).