

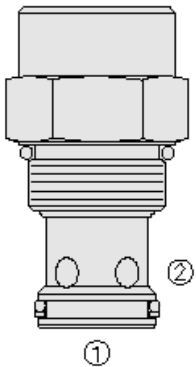

## Overview



### Description

A screw-in, cartridge style, fixed orifice, pressure compensated, hydraulic flow regulator valve (restrictive type).

### Operation

The FR16-20F maintains a constant flow rate from port 1 to 2 regardless of load pressure changes. Reverse flow returns through the control orifice and is non-compensated.

**note:** the valve is intended for use with mineral based or synthetic hydraulic fluids with lubricating properties.

### Features

- Hardened parts for long life.
- Quiet, modulated response.
- Cost-effective cavity.

### Symbol

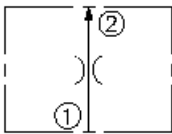

## Ratings

### Pressure Ratings

Pressure rating 241 bar (3500 psi)

### Flow Ratings

Flow setting 4 to 113 lpm (1 to 30 gpm)

### Temperature Ratings

Operating fluid temperature -40 to 120 °C (-40 to 248 °F)

## Properties

Materials steel with hardened work surfaces, external surfaces are zinc plated. Buna o-rings are standard

## Performance

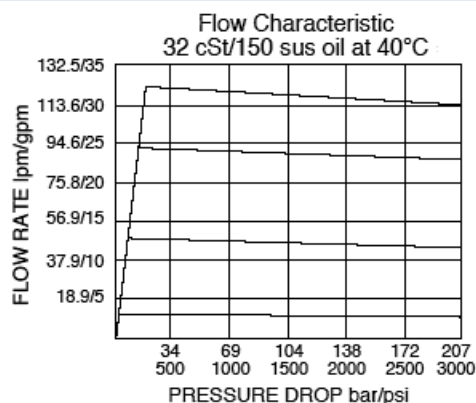

## Dimensions

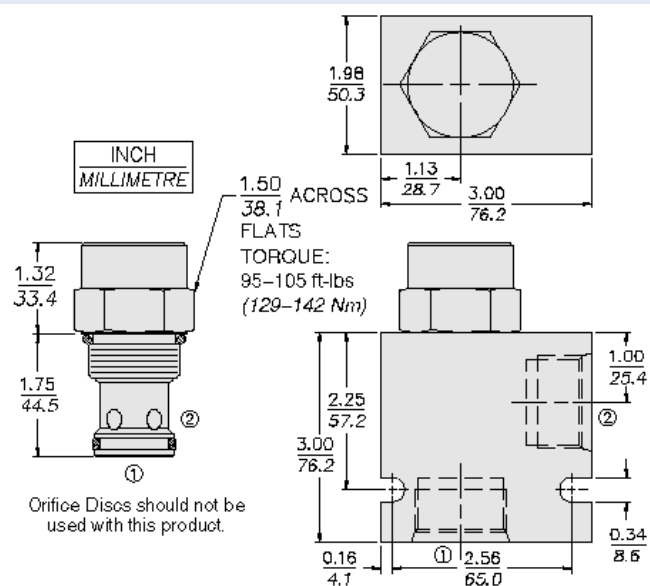

## Installation Specifications

Cavity	VC16-2
Cartridge installation torque	129 to 142 N-m (95 to 105 ft-lb)



## Order Code

FR16-20F -		-	-	/				
<u>Porting</u>					<u>Setting in lpm</u>			
Cartridge Only	0				Specify, for example:			
SAE 10	10TD				M4.0	4.0 lpm		
SAE 12	12T				M12.0	12.0 lpm		
SAE 16	16T				etc.			
3/4 in. BSP*	6B				<u>Setting in gpm</u>			
1 in. BSP*	8B				Specify, for example:			
*BSP Body; U.K. Mfr. Only					5.0	5.0 gpm		
					13.0	13.0 gpm		
					etc.			
<u>Seals</u>					<u>Drill Size Method</u>			
Buna N (Std.)	N				In thousandths of an inch.			
Fluorocarbon	V				Specify, for example:			
					D030	0.030 in. control orifice hole		
					etc.			

Note: Minimum drill diameter is 0.020 in.  
For smaller orifice sizes consult factory.

Note: Minimum drill diameter is 0.020 in.  
For smaller orifice sizes consult factory.

## Model Options

## FR16-20F-H-J-/T

## F Adjustment Option

CODE	DESCRIPTION
F	Factory Preset Non-Adjustable

## H Line Body

CODE	DESCRIPTION
0	No Body
12T	Aluminum SAE 12
16T	Aluminum SAE 16
12TD	Ductile Iron SAE 12
16TD	Ductile Iron SAE 16
6B	Aluminum BSPP 3/4" (6)
8B	Aluminum BSPP 1" (8)
8BD	Ductile Iron BSPP 1" (8)

## J Seal

CODE	DESCRIPTION
N	Buna-N
V	Fluorocarbon
P	Polyurethane
U	PPDI Urethane

## T Flow setting

CODE	DESCRIPTION
XX	Flow setting