

Flow control valves

Adjustable barrel type bidirectional restrictors

SD Series

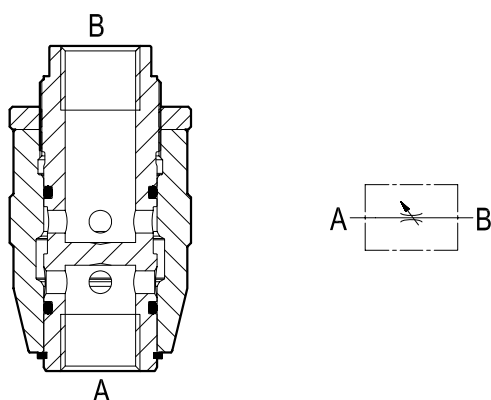

Description

This line mounted valve provides a fully adjustable restriction. Pressure compensation is not provided and flow depends from pressure drop and oil viscosity. Once the flow is adjusted, lock the knurled ring nut (H) in order to maintain the desired opening.

Minor leakage in both directions can be expected with valve fully closed.

With valve fully closed, max admitted pressure: 250 bar.

Performance

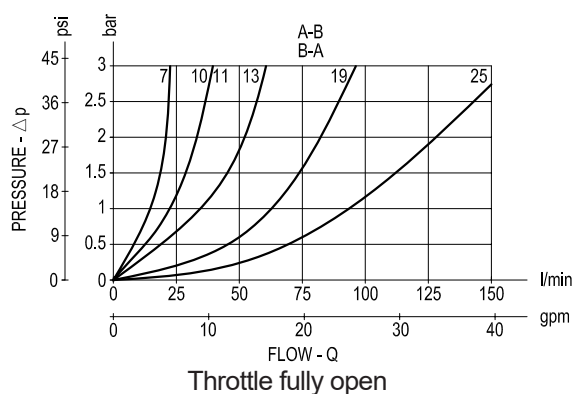

Technical data

Code	Pressure P max bar (psi)	Flow Q max l/min (gpm)	Weight kg (lbs)
SD 7	350 (5000)	12 (3)	0.29 (0.64)
SD 10	350 (5000)	30 (8)	0.39 (0.86)
SD 13	350 (5000)	45 (12)	0.69 (1.52)
SD 19	250 (3600)	80 (21)	1.08 (2.38)
SD 25	250 (3600)	140 (37)	3.0 (6.6)

Steel body, zinc plated

Advantages

- Compact design and inline mounting for space saving.
- Seven sizes provide great adaptability to the system.
- Easiness of adjustment.
- Mounting position is unrestricted.

Dimensions

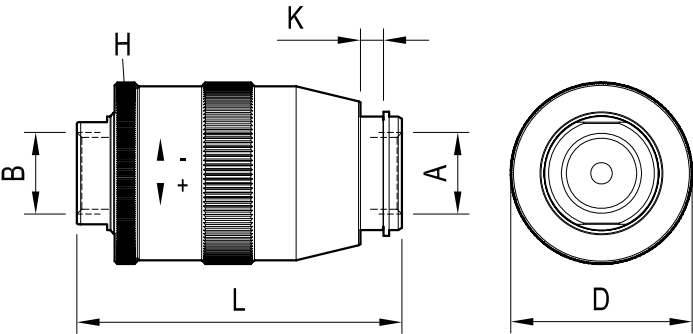

Ports size / Dimensions

Code	Ports size A-B	Ø D mm (inches)	L mm (inches)	K mm (inches)
SD 7	G 1/4	35 (1.38)	62 (2.44)	5 (0.20)
SD 10	G 3/8	38 (1.50)	72 (2.84)	7 (0.28)
SD 13	G 1/2	48 (1.89)	86 (3.39)	8 (0.32)
SD 19	G 3/4	55 (2.17)	100 (3.94)	11 (0.43)
SD 25	G 1	79 (3.11)	126 (4.96)	12 (0.47)

Applications

The SD Series valve is a fully and easily adjustable non-compensated flow control which can be employed for meter-in (Port A connected to the actuator inlet) or meter-out (Port B connected to the actuator outlet in order to control the oil flow from the actuator). The cost effectiveness and the easiness of adjustment make it suitable for many circuits and many applications where a non-compensated flow control is desired.

Ordering code

SD	
series 7	= 7
series 10	= 10
series 13	= 13
series 19	= 19
series 25	= 25

Type	Material number
SD 7	R932500579
SD 10	R932500580
SD 13	R932500581
SD 19	R932500582
SD 25	R932500583

Type	Material number

Type	Material number