

Flow control, 2-way pressure compensated fully adjustable

Common cavity

Cartridge style in manifold

VRFB-10A-C / VRFE-12A-C

ON.05 - K - X - Y - Z - W

Dimensions

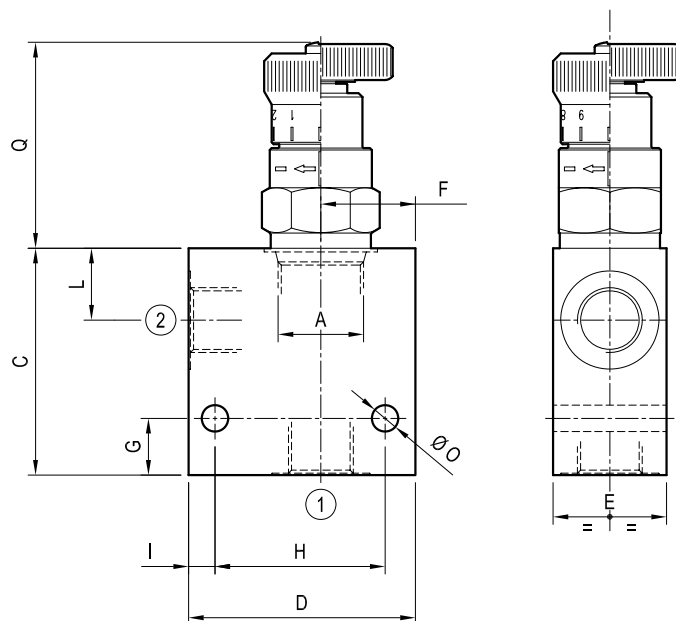

Technical data

Flow: adjustable (see table "Z" and performance graph)

Max operating pressure for steel body:	350 bar	(5000 psi)
Max operating pressure for aluminium body:	210 bar	(3000 psi)

To order only manifold see data sheet RE 18325-85

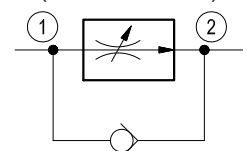
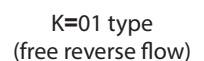
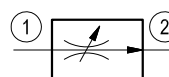
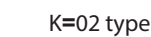

Table "Y"

[illegible]

Cartridge style

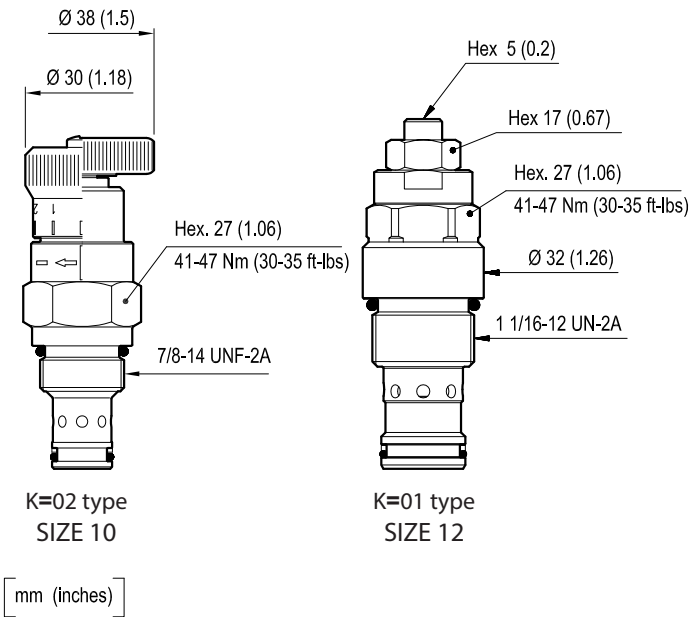

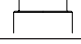

Table "K"

			K				
CARTRIDGE CODE	04	02	02	X	85	Z	VRFB-10A
	04	07	01	X	57	Z	VRFE-12A

Table "X"

X	ADJUSTMENTS	
40	Calibrated handknob (only for K=02)	
04	Handknob (only for K=02)	
03	Leakproof hex. socket screw (only for K=01)	

CARTRIDGE TECHNICAL DATA

Common cavity: CA-10A-2N, CA-12A-2N
For other details see data sheet RE 18321-16 and RE 18321-30

Table "Z"

[illegible]

Performance graphs

K = 02 type

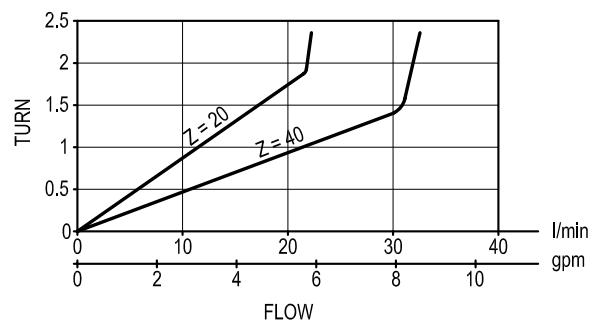
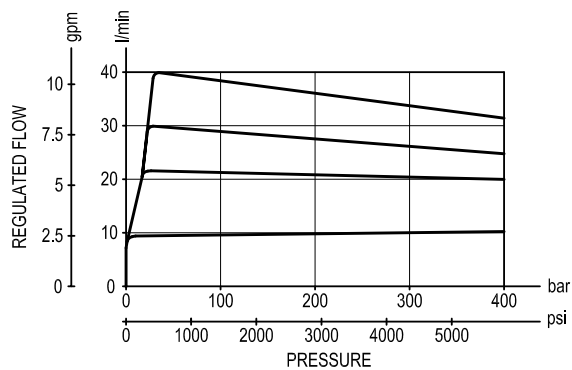

K = 01 type

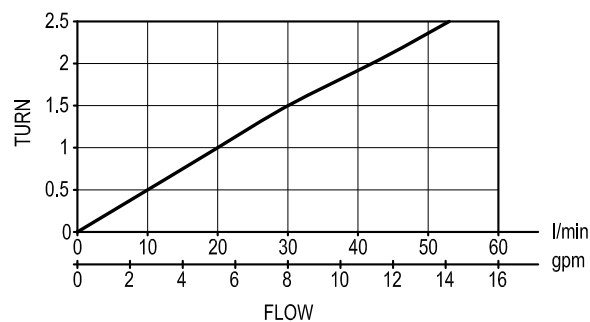
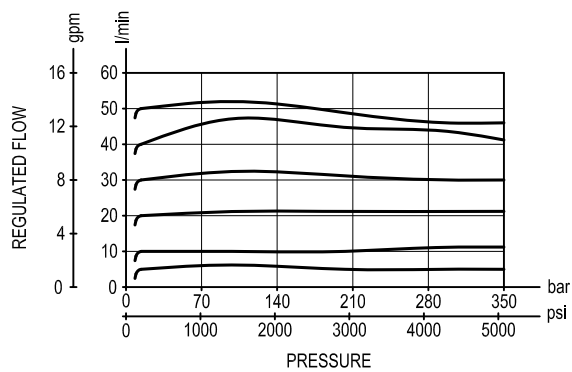

Ordering code

ON.05	K	X	Y	Z	W
-------	---	---	---	---	---

Manifold with flow control, 2-way pressure compensated fully adjustable

Cartridge style - Common cavity
(see table K on page 2)

Cartridge style - Adjustments
(see table X on page 2)

Manifold material

= 00	Aluminium manifold
------	--------------------

= S0 Steel manifold

Settings - Regulated flow range
(see table Z on page 2)

Manifold style - Dimensions and port sizes
(see table Y on page 1)

Preferred types (readily available)

[illegible][illegible]

Further types available by request