



Overview

Description

Magnet wire wound on a molded 30% glass filled bobbin framed in steel and encapsulated with 30% glass filled polyester resin. Coil impregnated with anerobic sealant.



Ratings

Properties

Magnet wire	U.S. class H 180 °C (356 °F) minimum rating
Mating connector	DT06-2S-P012 - Note: DEUTSCH DT04-2P DELPHI/PACKARD number 12010973 - Note: Weather-Pack 2 terminal male, lead wires 18 AWG

Electrical Parameters

Coil resistance	4.83 ohm $\pm 3\%$ - Note: At 20 °C (68 °F), 10 Vdc coil 7.2 ohm $\pm 3\%$ - Note: At 20 °C (68 °F), 12 Vdc coil 19.0 ohm $\pm 5\%$ - Note: At 20 °C (68 °F), 20 Vdc coil 28.8 ohm $\pm 5\%$ - Note: At 20 °C (68 °F), 24 Vdc coil 64.8 ohm $\pm 5\%$ - Note: At 20 °C (68 °F), 36 Vdc coil 568 ohm - Note: At 20 °C (68 °F), 115 Vdc coil 2304 ohm - Note: At 20 °C (68 °F), 230 Vdc coil
Coil initial current draw	2.07 A - Note: 10 Vdc coil 1.67 A - Note: 12 Vdc coil 1.05 A - Note: 20 Vdc coil 0.83 A - Note: 24 Vdc coil 0.56 A - Note: 36 Vdc coil 0.17 A - Note: 115 Vac coil 0.09 A - Note: 230 Vac coil
Coil initial power consumption	20 W

Bidirectional Zener Diode Parameters

Maximum clamping voltage	45.7 V - Note: 12 Vdc coil 64.8 V - Note: 24 Vdc coil
Maximum peak pulse current	13.2 A - Note: 12 Vdc coil 9.3 A - Note: 24 Vdc coil
Reverse standoff voltage	28.2 V - Note: 12 Vdc coil 40.2 V - Note: 24 Vdc coil
Maximum reverse leakage	5.0 μ A - Note: 12, 24 Vdc coil
Breakdown voltage	31.4 to 34.7 V - Note: 12 Vdc coil 44.7 to 49.4 V - Note: 24 Vdc coil
Diode part number	6110163 - Note: 12 Vdc coil (ref) 4000063 - Note: 24 Vdc coil (ref)

Unidirectional Diode Parameters

Average forward current	3.0 A - Note: Maximum, 12 Vdc coil 1 A - Note: Maximum, 24 Vdc coil
Maximum repetitive peak reverse voltage	50 V - Note: 12 Vdc coils 400 V - Note: 24 Vdc coils

Dimensions

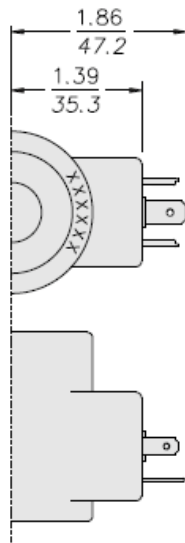

INCH
MILLIMETRE

G**DIN 43650
Connector**

Pins 1 and 2 are not
polarity-sensitive.
Ground pin is not used.

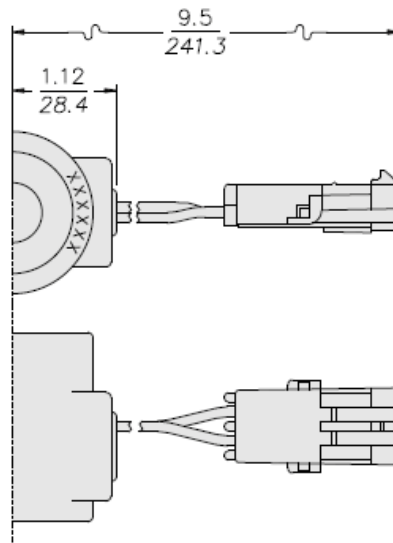
**W****Dual 18 Gauge Leads with
Weather Pack® Connector**

For use with Packard
part no. 12015792 female plug

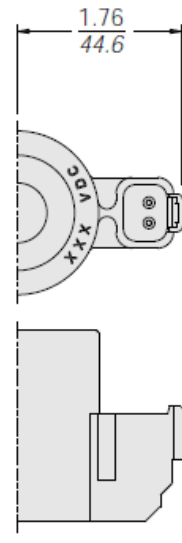
**DR****Integral Deutsch
Connector**

DR Models without Diode
DR/D Models with Diode
DR/Z Models with Zener Diode

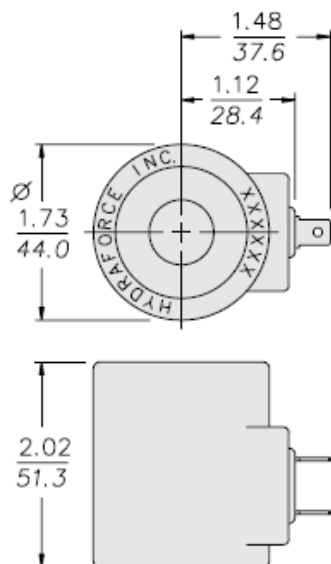

INCH
MILLIMETRE

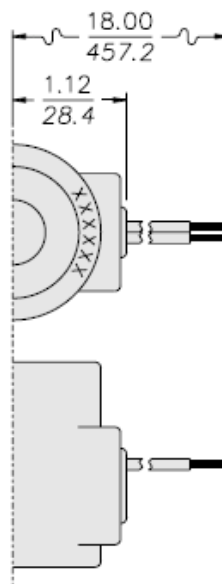
S**Dual Spades
SAE J858a****L****Dual Leads
18 Gauge**

Optional 36-inch leads
available. Consult factory.

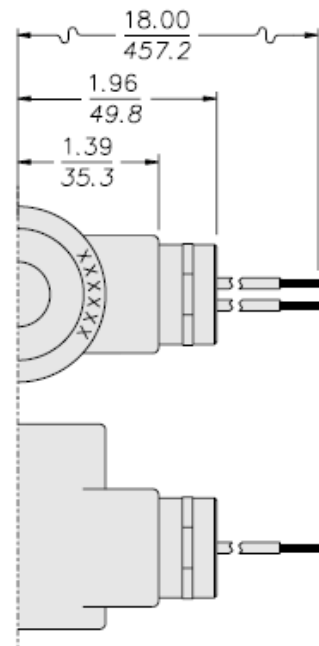
**P****1/2" Conduit &
18 Gauge Leads**



Coil Part Numbers